

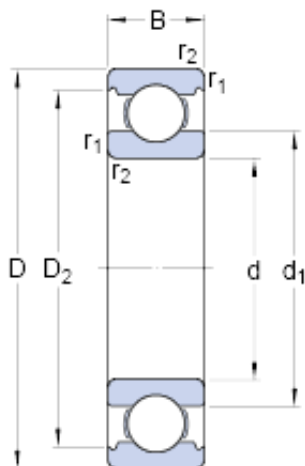

# Precision Bearing Industry Co., Ltd.



## Hot Sale! SKF High Precision Deep Groove Ball Bearing 6203 2RS/2z Ball Bearings

Bearing No. 6203

6203 Bearing 2D drawings and 3D CAD models

Size	40x17x12 mm
Bore Diameter	40 mm
Outer Diameter	17 mm
Width	12 mm
d	17 mm
D	40 mm
B	12 mm
d <sub>1</sub>	24.5 mm
D <sub>2</sub>	34.98 mm
r <sub>1,2</sub> - min.	0.6 mm
d <sub>a</sub> - min.	21.2 mm
D <sub>a</sub> - max.	35.8 mm
r <sub>a</sub> - max.	0.6 mm
Basic dynamic load rating - C	10 kN
Basic static load rating - C <sub>0</sub>	4.8 kN
Fatigue load limit - P <sub>u</sub>	0.2 kN
Reference speed	38000 r/min
Limiting speed	24000 r/min
Calculation factor - k <sub>r</sub>	0.025
Calculation factor - f <sub>0</sub>	13
Category	Single Row Ball Bearings
Inventory	0.0
Manufacturer Name	SKF
Minimum Buy Quantity	N/A



## Precision Bearing Industry Co., Ltd.

Weight / Kilogram	0.065
EAN	7316577087393
Product Group	B00308
Enclosure	Open
Precision Class	ABEC 1   ISO P0
Maximum Capacity / Filling Slot	No
Rolling Element	Ball Bearing
Snap Ring	No
Internal Special Features	No
Cage Material	Steel
Internal Clearance	C0-Medium
Inch - Metric	Metric
Long Description	17MM Bore; 40MM Outside Diameter; 12MM Outer Race Diameter; Open; Ball Bearing; ABEC 1   ISO P0; No Filling Slot; No Snap Ring; No Internal Special Features
Category	Single Row Ball Bearing
UNSPSC	31171504
Harmonized Tariff Code	8482.10.50.68
Noun	Bearing
Keyword String	Ball
Manufacturer URL	<a href="http://www.skf.com">http://www.skf.com</a>
Manufacturer Item Number	6203
Weight / LBS	0.15
Bore	0.669 Inch   17 Millimeter
Outer Race Width	0.472 Inch   12 Millimeter
Outside Diameter	1.575 Inch   40 Millimeter
d <sub>1</sub>	24.5 mm
D <sub>2</sub>	34.98 mm
d <sub>a</sub> min.	21.2 mm



## Precision Bearing Industry Co., Ltd.

$D_a$ max.	35.8 mm
$r_a$ max.	0.6 mm
Basic dynamic load rating C	9.95 kN
Basic static load rating $C_0$	4.75 kN
Fatigue load limit $P_u$	0.2 kN
Calculation factor $k_r$	0.025
Calculation factor $f_0$	13
Mass bearing	0.065 kg